



UX Series

MSL30WUX / 3,300lb

Electric Walkie Stacker

MSL30WUX features.

The Yale® MSL30WUX electric walkie stacker is a simply efficient solution that packs operator-friendly controls and technology in a cost-effective package for less-demanding applications. Backed by the Yale brand and nationwide dealer network, the UX Series electric walkie stacker comes with the quality and support operations need to keep moving efficiently.

Productivity

- Maintenance free AC motors
- Multi-function display with BDI and hour meter
- Handle equipped with emergency reversing button
- Auto deceleration function
- Low speed switch
- Variable speed control
- Side battery removal with rollers
- Mast cushioning for low-noise operation
- Built-in pressure relief valve helps protect the truck from overloading
- Emergency power disconnect switch
- 240Ah traction battery
- Cold storage configuration + (+ = *Optional equipment*)

Optimum structural design

- Low center of gravity helps enhance stability
- Full free lift mast options for low overhead clearance
- Durable plastic covers
- Adjustable balance caster wheel helps improve stability

Load charts

Load center chart

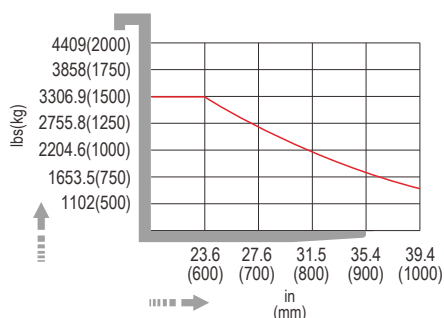

Serviceability

- Low voltage protection setting helps extend battery life
- CANbus technology
- Simple electronic components helps make troubleshooting and servicing more efficient
- Hall effect sensors help reduce wear and may increase component life



Standard control handle offers left and right hand operation

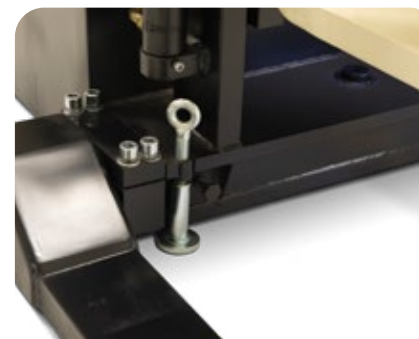

Straddle legs are adjustable

Load capacity chart

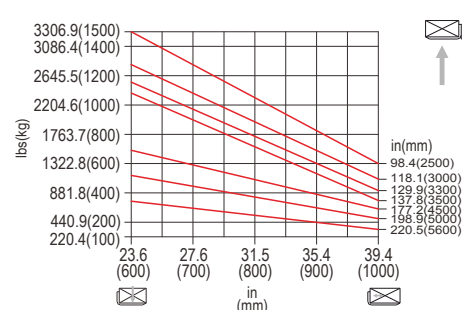

TRUCK DIMENSIONS MSL30WUX

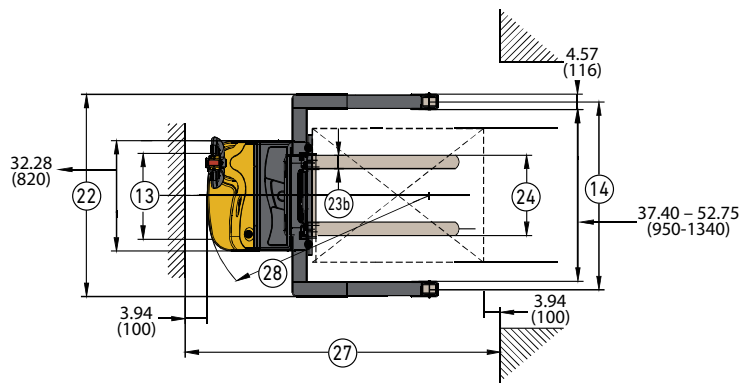
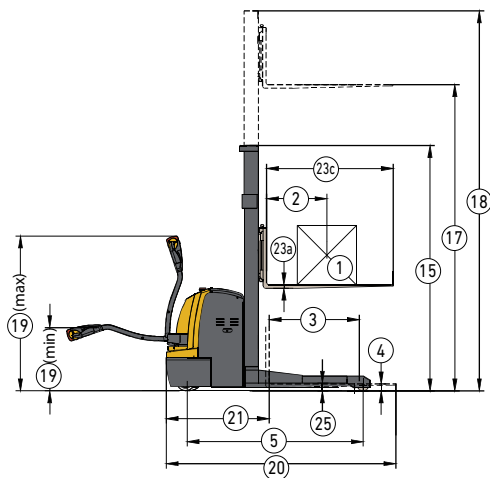

Circled truck dimensions correspond to the line numbers in the General Specifications chart. Dimensions are listed in inches (millimeters).

GENERAL SPECIFICATIONS MSL30WUX

Description	Measurement	MSL30WUX							
1 Load capacity	lb (kg)	3,300 (1500)							
2 Load center distance	in (mm)	24 (600)							
3 Load distance, center of drive axle to fork	in (mm)	27.5 (697)							
4 Fork height, lowered	in (mm)	2.75 (70)							
5 Wheelbase	in (mm)	60 (1420)							
6 Axle loading, laden front/rear	lb (kg)	3,175 (1440) / 2,825 (1280)							
7 Axle loading, unladen front/rear	lb (kg)	1,920 (870) / 775 (350)							
8 Tires		polyurethane							
9 Tire size, front	in (mm)	10 (250) × 2.75 (70)							
10 Tire size, rear	in (mm)	3.25 (80) × 3.5 (84)							
11 Additional wheels (dimensions)	in (mm)	6 (150) × 2.5 (60)							
12 Wheels, number front rear (x=driven wheels)		1x+1/4							
13 Tread, front	in (mm)	20.5 (520)							
14 Tread, rear	in (mm)	41 (1040) - 56.5 (1430)							
15 Mast height, lowered	in (mm)	71 (1805)	81 (2055)	87 (2205)	91 (2305)	84 (2120)	90 (2280)	98 (2480)	
16 Free lift	in (mm)	51.5 (1300)	61 (1550)	67 (1700)	71 (1800)	62 (1570)	58.5 (1740)	76.5 (1940)	
17 Max. lift height	in (mm)	98.5 (2500)	118.25 (3000)	130 (3300)	138 (3500)	177.25 (4500)	197 (5000)	220.5 (5600)	
18 Mast height, extended	in (mm)	119 (3025)	139 (3525)	151 (3825)	158.5 (4025)	200 (5080)	219 (5560)	242.5 (6160)	
19 Height of tiller in drive position min./max.	in (mm)	26.5 (670) / 51 (1300)							
20 Overall length	in (mm)	78 (1980)							
21 Length to face of forks	in (mm)	36 (915)							
22 Overall width	in (mm)	46 (1170) - 61.5 (1560)							
23a Fork dimensions	in (mm)	1.4 (35)							
23b Fork dimensions	in (mm)	3.9 (100)							
23c Fork dimensions	in (mm)	42.12 (1070) / 45.28 (1150)							
24 Width overall forks	in (mm)	8 (200) - 31.5 (800)							
25 Ground clearance, center of wheelbase	in (mm)	1.5 (35)							
26 Aisle width for pallets 1000x1200 crossways	in (mm)	98 (2480)							
27 Aisle width for pallets 800x1200 lengthways	in (mm)	97 (2465)							
28 Turning radius	in (mm)	63.5 (1610)							
29 Travel speed, laden/unladen	mph (Km/h)	3.60 (5.8) / 3.75 (6)							
30 Lift speed, laden/unladen	ft/min (m/s)	21.75 (0.11) / 29.5 (0.15)							
31 Lowering speed, laden/unladen	ft/min (m/s)	23.5 (0.12) / 23.5 (0.12)							
32 Max. gradeability, laden/unladen	%	8 / 15							
33 Service brake		Electromagnetic							
34 Battery voltage, nominal capacity K5	V/Ah	24 / 240							
35 Battery weight	lb (kg)	530 (240)							
36 Battery dimensions l/w/h	in (mm)	26.5 (675) x 10 (254) x 19.75 (500)							
37 Sound lever at the driver's ear acc. to DIN12503	dB (A)	65							
38 Service weight (without battery)	lb	2,601 (1180) / 2,657 (1205) / 2,690 (1220) / 2,715 (1230) 2,825 (1280) / 2,870 (1300) / 2,910 (1320)							

About Yale®



Yale Materials Handling Corporation is one of the oldest manufacturers of lift trucks in the world. We've been in the business of lifting since 1875 and we apply that experience to help customers solve materials handling challenges. Our full line of lift trucks range in capacity from 2,000 to 36,000 pounds and are powered by internal combustion engines or electric options. Yale also offers robotic solutions, telemetry, fleet management, parts, financing and training. From traditional lift truck equipment to emerging technologies, our goal, every day, is to work with our nationwide dealer network to continually improve and provide the solutions you need, when and how you need them.

MATERIALS HANDLING FOR:



3PL



Auto Parts
Distribution



Beverage



Cold & Frozen
Foods



Food
Distribution



Food
Processing



Furniture &
Furnishings



Government



Health &
Pharma



Home
Centers



Retail &
E-Commerce

Yale Materials Handling Corporation

P.O. Box 7367
Greenville, NC 27835-7367
U.S.A.

www.yale.com

YALE,  and PEOPLE. PRODUCTS. PRODUCTIVITY. are trademarks, service marks or registered marks in the United States and certain other jurisdictions. © Yale Materials Handling Corporation 2021. All Rights Reserved.

Trucks may be shown with optional equipment. Truck performance may be affected by the condition of the vehicle, how it is equipped and the application. Specifications are subject to change without notice. Consult your Yale® Dealer if any of the information shown is critical to your application.